

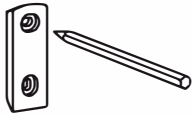

1.

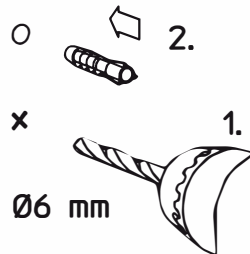

2.

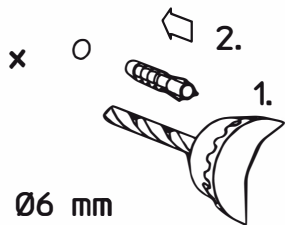
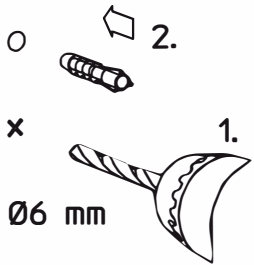

3.

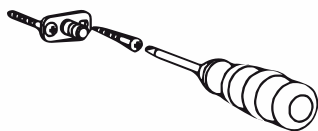

4.

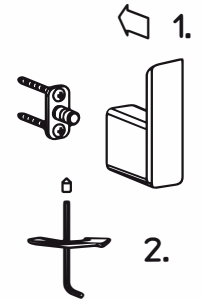
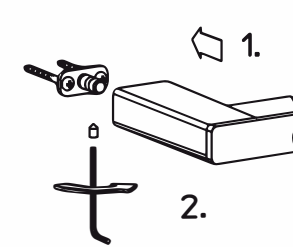
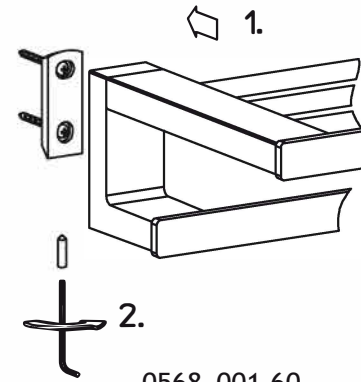

0568 001 60

0550 001 42
0550 001 32
0561 001 60
0561 001 80

0505 001 01
0505 001 02

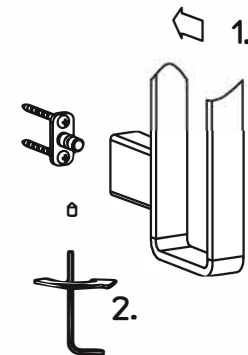
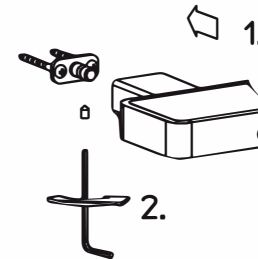

0566 001 40
0566 001 60

0550 001 40

5.

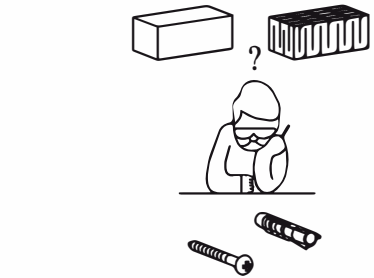

1.

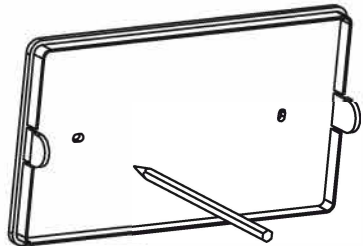

2.

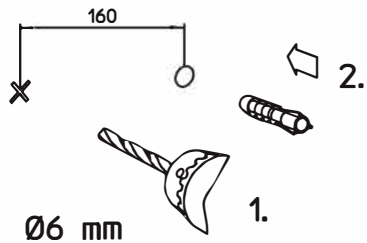

3.

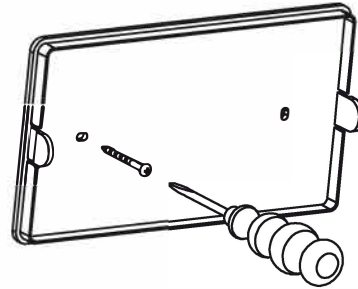

4.

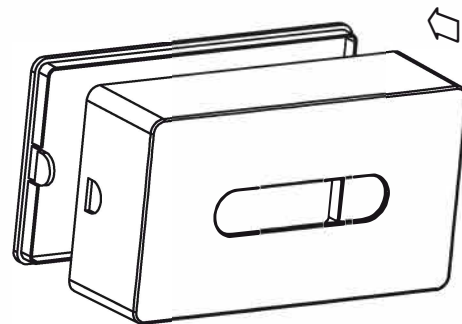

5.

0557 001 00

ACHTUNG:

Das beigelegte, universelle Befestigungsmaterial ist nicht für alle Untergründe geeignet. Bitte verwenden Sie nur - für den jeweiligen Untergrund - geeignete Schrauben und Dübel. Bitte prüfen Sie deshalb vor der Verwendung sorgfältig, ob das beigelegte Befestigungsmaterial für den vorgesehenen Untergrund tauglich ist.

CAUTION:

The universal fastening accessories supplied with the product are not suitable for all substrates. Please only use screws and plugs that are suitable for the substrate concerned. Therefore, before using the accessories, please carry out a thorough check to ensure that the fastening accessories supplied with the product are suitable for the intended substrate.

ATTENTION :

le matériel de fixation universel fourni ne convient pas atous les supports. Veuillez utiliser uniquement les vis et les chevilles appropriées au support respectif. C'est pourquoi, nous vous prions de vérifier s'ogneusement avant toute utilisation si le matériel de fixation fourni est compatible avec le support prévu.

ATENCION:

El material de fijación universal adjunto no es apto para todos los fondos. Le rogamos que utilice solo los tornillos y espigas apropiados para cada fondo. Por ello, compruebe con seguridad si el material de fijación adjunto es sumergible en el fondo en cuestión.

OPGELET!

Het bijgeleverde, universele bevestigingsmateriaal is niet geschikt voor alle ondergronden. G ebruik alleen schroeven en pluggen die geschikt zijn voor de betreffende ondergrond. Controleer daarom a.u.b. v66r gebruik zorgvuldig of het bijgeleverde bevestigingsmateriaal geschikt is voor de bestaande ondergrond.